L&T Hydraulics manufactures and supports a wide range of high pressure hydraulic products, hydrostatic transmissions and customised hydraulic systems. The hydraulic products are manufactured at the state-of-the-art manufacturing plant of L&T Hydraulics in Bengaluru, India.



L&T Hydraulics

HIGH TORQUE LOW SPEED HYDRAULIC MOTORS

HTLS Motors are designed to delivery very high torque even at a speed under 1 rpm. They can operate up to a maximum pressure of 450 bar.

SHAFT MOTOR

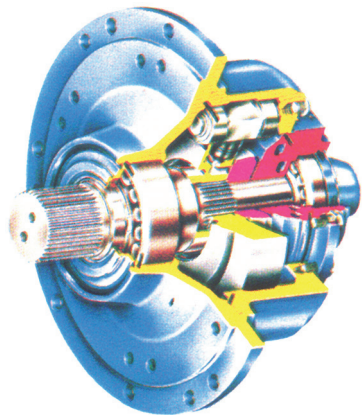

Type	Displacement cu cm/rev	Torque at 400 bar m. daN	Max Speed in rpm Full disp	Maximum power		Braking torque m. daN	Radial load tonnes
H15	1130	720	150	52	70	610	9.0
H20	1979	1260	120	75	100	940	13.6
H25	3122	1980	100	100	135	1470	18.0

MAIN DIMENSIONS

	A dia mm	B dia mm	C dia mm	D dia mm	E dia mm	Weight	
						w/o brake kg	with brake kg
H15	75	380	445	301	392	115	150
H20	100	480	568	328	436	200	250
H25	120	510	623	373	485	285	345

Options available :

- Free wheeling
- Flushing port
- With/without brake
- Keyed/splined shaft
- Anti-cavitation springs

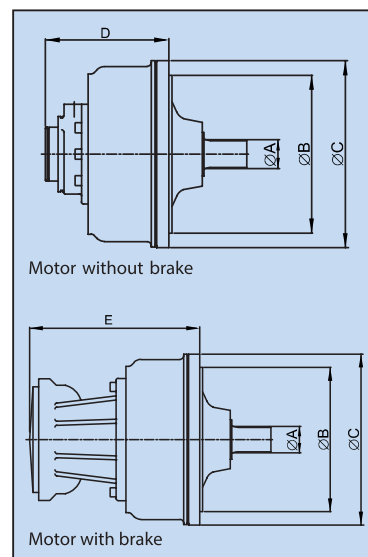

WHEEL MOTOR

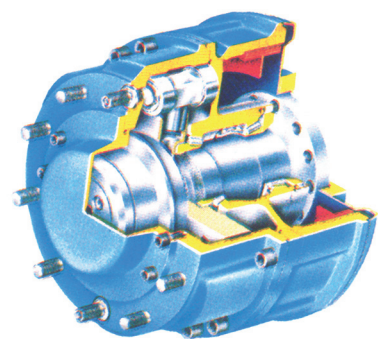

Type	Displacement cu cm/rev	Torque at 400 bar m. daN	Max speed		Maximum power		Braking torque m. daN	Radial load tonnes
			Full disp	Small disp	KW	HP		
H15	1130	720	150	220	52	70	660	12.0
H20	1979	1260	120	180	75	100	1000	15.3
H25	3122	1980	100	150	100	135	1500	24.6

MAIN DIMENSIONS

	A dia mm	B dia mm	C dia mm	D mm	E mm	F mm	G mm	Weight	
								w/o brake kg	with brake kg
H15	355	221	275	411	160	309	319	118	153
H20	450	281	335	475	190	358	368	175	233
H25	485	281	335	560	220	418	438	277	408

Options available :

- Free wheeling
- With/without brake
- Dual displacement

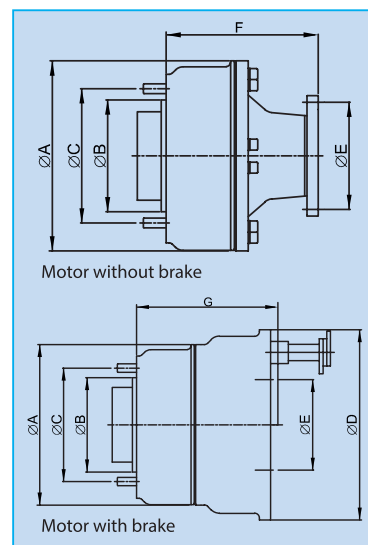

COMPACT MOTOR

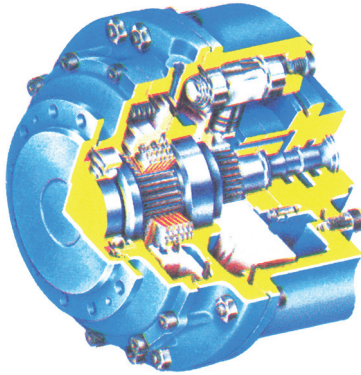

Type	Displacement cu cm/rev	Torque at 400 bar m. daN	Max speed		Maximum power		Braking torque m. daN	Radial load tonnes
			Full disp	Small disp	KW	HP		
H15	1130	720	150	220	52	70	700	4.0
H20	1979	1260	120	180	75	101	1100	5.4
H25	3122	1980	100	150	100	135	1740	7.2

MAIN DIMENSIONS

	A dia mm	B dia mm	C dia mm	D mm	E mm	F mm	Weight	
							w/o brake kg	with brake kg
H15	355	185	200	174	290	85	145	170
H20	450	220	254	198	314	106	197	223
H25	485	221	275	230	380	106	270	290

Options available :

- Free wheeling
- Dual displacement
- With/without brake
- Anti-cavitation springs

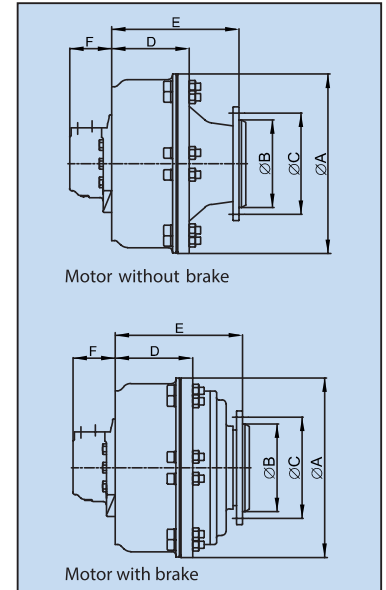

TORQUE MOTOR

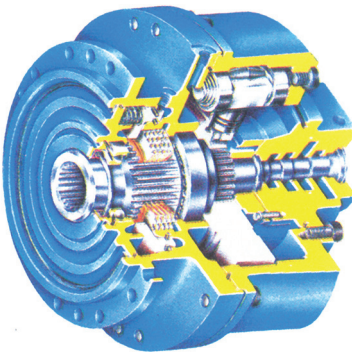

Type	Displacement cu cm/rev	Torque at 400 bar m. daN	Max speed		Maximum power		Braking torque m. daN
			Full disp	Small disp	KW	HP	
H15	1130	180	150	220	52	70	355
H20	1979	315	120	180	75	100	600
H25	3122	495	100	150	100	134	940

MAIN DIMENSIONS

Type	A dia mm	B dia mm	C dia mm	D mm	E mm	F mm	Weight kg
H15	365	250	280	180	268	85	130
H20	460	310	350	205	292	106	200
H25	490	310	350	231	328	106	270

Options available :

- Free wheeling
- Dual displacement
- With/without brake
- Anti-cavitation springs

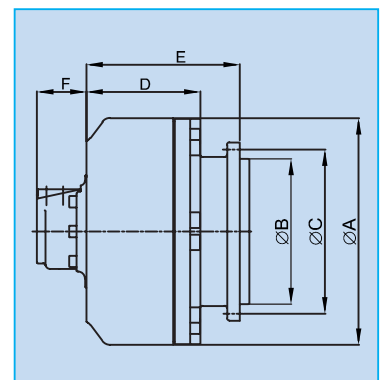

TURNING JOINT

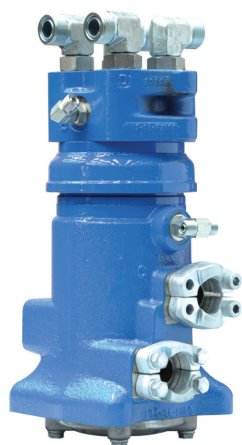

Turning joints are ideal when a 360° continuous rotation is required to transfer fluid power between two rotating components. The turning joints are designed & manufactured to suit customer requirements

L&T offers turning joints with the following specification:

Number of ports : Up to 16 numbers

Pressure range : Up to 350 Bars operating pressure

Medium of fluid : Hydraulic oil

Flow handled : Up to 700 lpm

Requirements beyond the above range available on request.

Turning joints find application in hydraulic excavators, mobile cranes, wagon tipplers, etc.

CYLINDERS

L&T offers heavy duty, double acting type cylinders in the following range:

Bore diameter : Up to 360 mm

Stroke : Up to 4000 mm

Maximum operating : Up to 700 bar pressure

End mounting : Eye end, trunnion, flange, foot or any other type, depending on requirement

The cylinders are used in hydraulic excavators, wheel loaders, loaders backhoes, mobile cranes, dumpers and various other applications.



Backed by over 30 years of experience in manufacturing and designing high pressure hydraulic products and systems, L&T Hydraulics has always been in line with the recent developments and trends in the field of Hydraulics. L&T Hydraulics has continued to invest effectively on the research and development of new hydraulic products.

Radial Piston 400 cc Hydraulic Motor



The 400 cc motor is of a cam lobe radial piston design. The motor has been designed for delivering high torques at low speeds. The wheel drive version is designed for use on a vibratory compactor and has an inbuilt parking brake.

Displacement	Torque @ 400 Bar	Max. Speed	Max. Power	Static Braking Torque
400 cc/rev	250 Kg-m	225 RPM	22 Kw	250 Kg-m

RADIAL PISTON PUMPS

Radial piston multi-flow pumps are capable of withstanding a maximum operating pressure of up to 350 bar, depending on the model.

Range

Displacement - cc/rev 5, 10, 20, 28, 5, 58, 65, 85, 100, 127

Possible number of flows available: 1, 2, 3, 4, 6

Direction of rotation : Right hand or left hand

Some of the models are:

Model No.	Displacement	No. of flows
L2H10	5 cc/rev	2
L4H10	10 cc/rev	4
L1H14	20 cc/rev	1
L1H14	28.5 cc/rev	1
L2H14	20 cc/rev	2
L2H14	28.5 cc/rev	2
L3H14	20 cc/rev	3
L3H14	28.5 cc/rev	3
L4H14	20 cc/rev	4
L4H14	28.5 cc/rev	4
L6H14	20 cc/rev	6
L6H14	28.5 cc/rev	6
L6H20	58 cc/rev	6
L6H20	65 cc/rev	6
L6H20	85 cc/rev	6
L6H20	100 cc/rev	6
L6H20	127 cc/rev	6

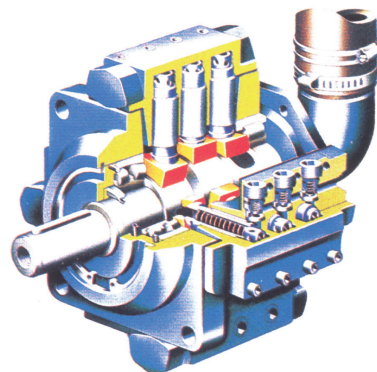

CUSTOMISED HYDRAULIC SYSTEMS

L&T offers customised hydraulic systems for various applications in the engineering, chemical and sugar industries.

Some of the applications are:

- Hydraulic drive for sugarcane crushing mills.
- Hydraulic transmission for shunting locomotives

Hydraulic systems for:

- * Paddle feeders
- * Side arm charges
- * Wagon tipplers
- * Cranes
- * Chemical agitators
- * Material handling and conveying systems.

Axial Piston 28.5 cc Hydraulic Motor



The 28.5 cc motor is of an axial piston type. The motor has been designed for continuous duty where reliability is of prime importance. The motor offers very stable torque under variable speed conditions and starting.

Displacement	Torque @ 275 Bar	Max. Speed	Max. Power
28.5 cc/rev	12.7 Kg-m	4700 RPM	62 KW

Wagon Tippler

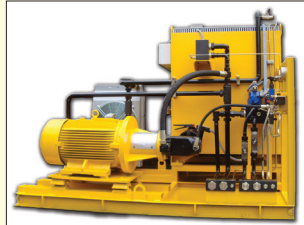

*Power Pack for Wagon
Clamp & Tippler Drive*

Side Arm Charger



*Power Pack for Side Arm
Charger Travel Drive*

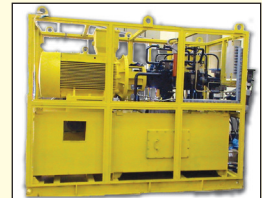

Paddle Feeder



Power Pack and Drive

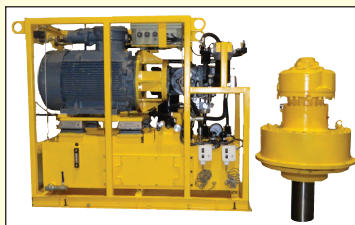

Railway Crane



*Hydraulic Winch,
Slew and Travel
drives for Crane*



Water Well Drill



*Hydraulic Pump
for Drill Drive,
Feed & Auxiliaries*

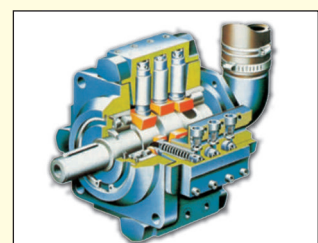

*Hydraulic Motor for
travel & pull-down drive*

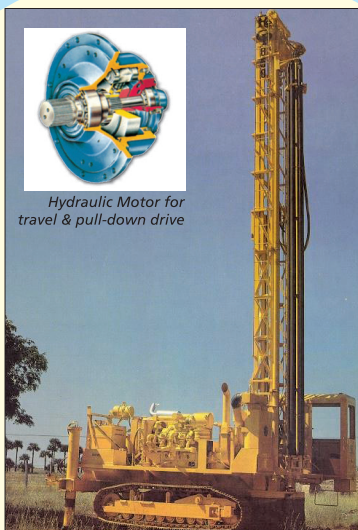

Blast Hole Drill

Manufacturing Facility & Marketing Office:

L&T Construction Equipment Limited

Marketing – Hydraulic Products

Sy. No. 28 Thammashetti Halli

Raghunathapura, Doddaballapur Taluk

Bengaluru – 561 203

Tel: +91 80 2217 5215, +91 80 2217 5208, 9482572470

Email: deepakkumar.shukla@larsentoubro.com

Website: HYPERLINK "<http://www.Lnt-hydraulics.com>" www.Lnt-hydraulics.com

Regional Office:

L&T Construction Equipment Limited

Marketing - Hydraulic Products

3B, Shakespeare Sarani

Kolkata 700 071

Tel +91 33 22827522

Email: avik.halder@larsentoubro.com

Mobile: 94330 93865

L&T Construction Equipment limited is a wholly owned subsidiary of Larsen & Toubro Limited

CIN: U29119MH1997PLC109700



L&T Hydraulics

L&T Hydraulics is a brand of Larsen & Toubro Limited